

A NATURAL EXTENSION TO YOUR ARM!
...the new kwb range of screwdrivers for everyone.



THE ADVANTAGES OF kwb SCREWDRIVERS



- CrV steel
- with 3-component grip for optimal power transfer and non-slip working
- blade CrV steel
- with chemically blacked precision tips
- VDE Screwdriver, VDE/GS tested
- quickly distinguishable colour code system
- practical screwdriver holder for the workshop, simply screw the plastic clip on the workshop wall

FIND THE APPROPRIATE SCREW SHAPE QUICKLY AND EASILY

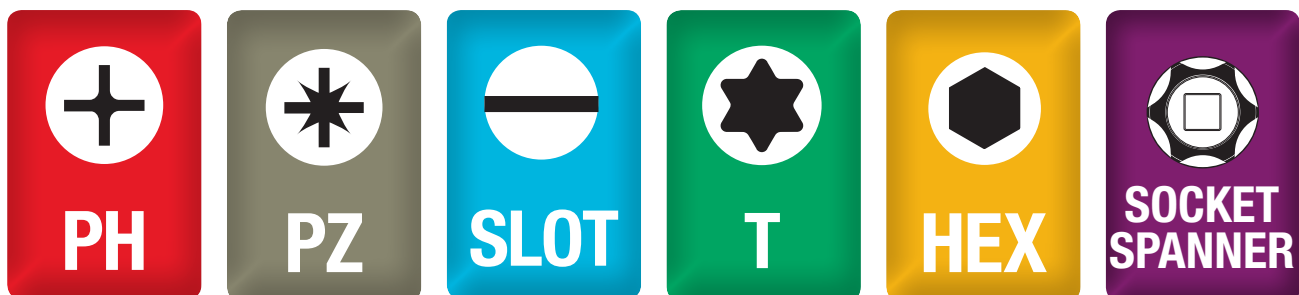

PACKAGING CLIP CAN BE USED AS CONVENIENT TOOL HOLDER

MUST HAVE

Simply fix the clip with 2 screws on the tool wall ...

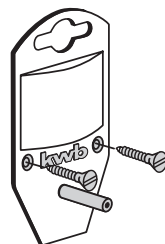

... then hang up the screwdrivers - and have the right screwdrivers readily to hand!

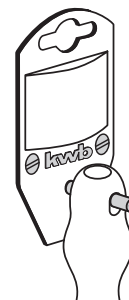

RANGE OVERVIEW SREWDRIVERS



Engineer's screwdrivers

PROFESSIONAL ★★★★★

CrV steel, 3-component grip for optimal power transfer and slip-free working, blade CrV steel, matt chrome plated, with chemically blacked precision tips. Quickly distinguishable colour code system shows the desired blade shape. With practical screwdriver holder for the workshop, simply screw the plastic clip on the workshop wall.



Stubby screwdrivers

PROFESSIONAL ★★★★★

CrV steel, 3-component grip for optimal power transfer and slip-free working, matt chrome plated, with chemically blacked precision tips. Quickly distinguishable colour code system shows the desired blade shape. With practical screwdriver holder for the workshop, simply screw the plastic clip on the workshop wall.

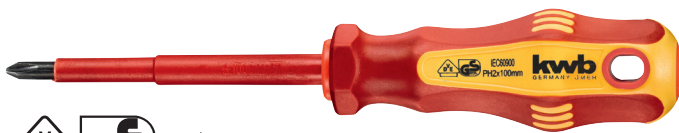

1000 V

VDE screwdrivers

PROFESSIONAL ★★★★★

VDE certified, CrV steel, 3-component grip for optimal power transfer and non-slip working, blades fully insulated, with chemically blacked precision tips. Quickly distinguishable colour code system shows the desired blade shape. With practical screwdriver holder for the workshop, simply screw the plastic clip on the workshop wall.



Voltage tester

PROFESSIONAL ★★★★★

VDE GS tested, 150-250 volt, with visual indication, with clip, insulated head, insulated blade, for testing whether a voltage is present.



T-grip screwdriver

PROFESSIONAL ★★★★★

with hanger for the workshop wall, simply screw the plastic clip on the workshop wall. CrV steel, 2-component grip for high power transfer and slip-free working, chrome plated, short and long blade, for significantly more powerful working as compared to conventional screwdrivers. Colour code system on the package for easier allocation to different applications.



PROFI precision screwdrivers

PROFESSIONAL ★★★★★

Blades from CrV steel matt chrome plated, 2-component handle, with rotating top for optimal power transfer and easy working in precision engineering, with chemically blacked precision tips.

TECHNICAL TERMS



Identification

Symbol on the end of the handle shows the blade type and size.

Hanging hole

For space-saving and orderly hanging in the workshop. Distinguishable colour code system shows the desired blade shape.

Handle

3-component grip for optimal power transfer and non-slip working.

Colour coding system

Easily recognisable colour coding system instantly indicates the required blade type.



Insulation

All insulated screwdrivers are VDE/GS tested and conform to the standard IEC 60900:2004.

Blade

Chrome-vanadium (CrV) steel, matt chrome plated, with chemically blacked precision tips.

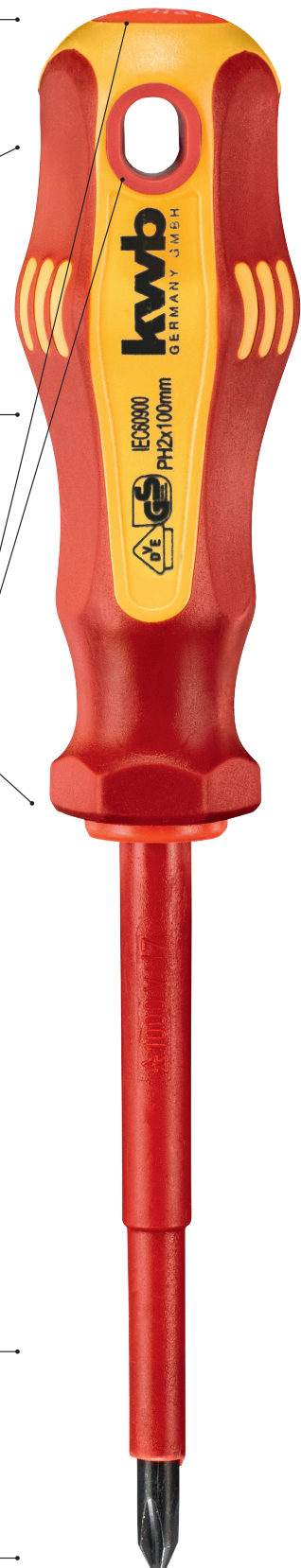

TECHNICAL TERMS



Design

The flat-headed rotatable top enables fine adjustment, particularly useful in precision engineering.

Colour coding system

Easily recognisable colour coding system instantly indicates the required blade type.



Handle

3-component grip for optimal power transfer and non-slip working.

Identification

Symbol on the end of the handle shows the blade type and size.

Blade

Chrome-vanadium (CrV) steel, matt chrome plated, with chemically blacked precision tips.

kwb Screwdriver

kwb
GERMANY GMBH

Engineer's screwdrivers

PROFESSIONAL ★★★★★



CrV steel, 3-component grip for optimal power transfer and slip-free working, blade CrV steel, matt chrome plated, with chemically blacked precision tips. Quickly distinguishable colour code system shows the desired blade shape. With practical screwdriver holder for the workshop, simply screw the plastic clip on the workshop wall.



Art.-No.	mm x mm			Barcode
⊕ Cross slot / Phillips				
662200	PH0 x 60 mm		2	4 009316 622001
662201	PH1 x 80 mm		2	4 009316 622018
662202	PH2 x 100 mm		2	4 009316 622025
662203	PH3 x 150 mm		2	4 009316 622032

Engineer's screwdrivers

PROFESSIONAL ★★★★★



CrV steel, 3-component grip for optimal power transfer and slip-free working, blade CrV steel, matt chrome plated, with chemically blacked precision tips. Quickly distinguishable colour code system shows the desired blade shape. With practical screwdriver holder for the workshop, simply screw the plastic clip on the workshop wall.



Art.-No.	mm x mm			Barcode
⊕ Pozidriv				
663200	PZ0 x 60 mm		2	4 009316 632000
663201	PZ1 x 80 mm		2	4 009316 632017
663202	PZ2 x 100 mm		2	4 009316 632024
663203	PZ3 x 150 mm		2	4 009316 632031

Engineer's screwdrivers

PROFESSIONAL ★★★★★

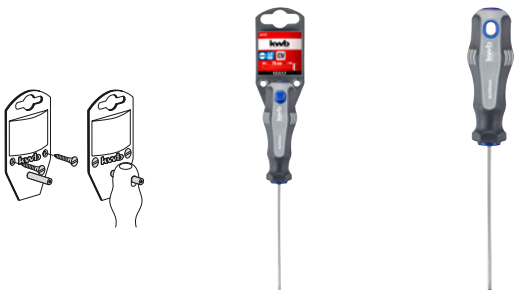

CrV steel, 3-component grip for optimal power transfer and slip-free working, blade CrV steel, matt chrome plated, with chemically blacked precision tips. Quickly distinguishable colour code system shows the desired blade shape. With practical screwdriver holder for the workshop, simply screw the plastic clip on the workshop wall.



Art.-No.	mm x mm			Barcode
⊖ Plain slot				
661235	3.5 x 75 mm		2	4 009316 612354
661240	4.0 x 75 mm		2	4 009316 612408
661255	5.5 x 100 mm		2	4 009316 612552
661265	6.5 x 125 mm		2	4 009316 612651
661280	8.0 x 175 mm		2	4 009316 612804
661299	10.0 x 200 mm		2	4 009316 612996

Screwdriver

Engineer's screwdrivers

PROFESSIONAL ★★★★★



CrV steel, 3-component grip for optimal power transfer and slip-free working, blade CrV steel, matt chrome plated, with chemically blacked precision tips. Quickly distinguishable colour code system shows the desired blade shape. With practical screwdriver holder for the workshop, simply screw the plastic clip on the workshop wall.

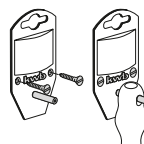

Art.-No.	mm x mm			Barcode
⊕ T				
669210	T10 x 80 mm		2	4 009316 692103
669215	T15 x 80 mm		2	4 009316 692158
669220	T20 x 100 mm		2	4 009316 692202
669225	T25 x 100 mm		2	4 009316 692257
669230	T30 x 115 mm		2	4 009316 692301
669240	T40 x 130 mm		2	4 009316 692400



Screwdriver set, 5pc.

PROFESSIONAL ★★★★★

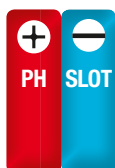

CrV steel, 3-component grip for optimal power transfer and fatigue-free working, blade CrV steel, matt chrome plated, with chemically blacked precision tips. Quickly distinguishable colour code system shows the desired blade shape.



Art.-No.	Content			Barcode
665205	⊕ P1 80 mm PH2 100 mm ⊖ 3.5 x 75 mm 5.5 x 100 mm 6.5 x 125 mm		2	4 009316 652053



Screwdriver set, 6pc.

PROFESSIONAL ★★★★★



CrV steel, 3-component grip for optimal power transfer and fatigue-free working, blade CrV steel, matt chrome plated, with chemically blacked precision tips. Quickly distinguishable colour code system shows the desired blade shape.



Art.-No.	Content			Barcode
665216	⊕ T10, T15, T20, T25, T27, T30		2	4 009316 652169



kwb Screwdriver

Screwdriver set, 7pc.

PROFESSIONAL ★★★★★



CrV steel, 3-component grip for optimal power transfer and fatigue-free working, blade CrV steel, matt chrome plated, with chemically blacked precision tips. Quickly distinguishable colour code system shows the desired blade shape.

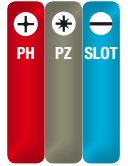

Art.-No.	Content			Barcode
665207	⊕P-:1 80 mm PH2 100 mm ⊕PZ1 80 mm PZ2 100 mm ⊖5.5 x 100 mm 6.5 x 125 mm 1 Voltage tester		2	4 009316 652077

Stubby screwdrivers

PROFESSIONAL ★★★★★

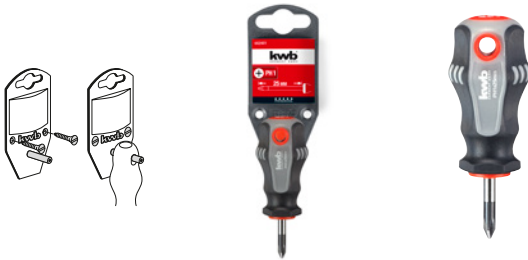

CrV steel, 3-component grip for optimal power transfer and slip-free working, matt chrome plated, with chemically blacked precision tips. Quickly distinguishable colour code system shows the desired blade shape. With practical screwdriver holder for the workshop, simply screw the plastic clip on the workshop wall.



Art.-No.				Barcode
⊕ Cross slot / Phillips				
662401	PH1 x 25 mm		2	4 009316 624012
662402	PH2 x 25 mm		2	4 009316 624029

Stubby screwdrivers

PROFESSIONAL ★★★★★



CrV steel, 3-component grip for optimal power transfer and slip-free working, matt chrome plated, with chemically blacked precision tips. Quickly distinguishable colour code system shows the desired blade shape. With practical screwdriver holder for the workshop, simply screw the plastic clip on the workshop wall.



Art.-No.				Barcode
⊕ Pozidriv				
663401	PZ1 x 25 mm		2	4 009316 634011
663402	PZ2 x 25 mm		2	4 009316 634028

Screwdriver

Stubby screwdrivers

PROFESSIONAL ★★★★★



CrV steel, 3-component grip for optimal power transfer and slip-free working, matt chrome plated, with chemically blacked precision tips. Quickly distinguishable colour code system shows the desired blade shape. With practical screwdriver holder for the workshop, simply screw the plastic clip on the workshop wall.

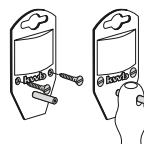

Art.-No.	mm x mm	Icon	Quantity	Barcode
Plain slot				
661455	5.5 x 38 mm	Icon	2	4 009316 614556
661465	6.5 x 38 mm	Icon	2	4 009316 614655

Electrical screwdrivers

PROFESSIONAL ★★★★★



CrV steel, 3-component grip for optimal power transfer and fatigue-free working, matt chrome plated, with chemically blacked precision tips. Quickly distinguishable colour code system shows the desired blade shape. With practical screwdriver holder for the workshop, simply screw the plastic clip on the workshop wall.

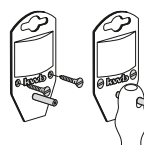

Art.-No.	mm x mm	Icon	Quantity	Barcode
Plain slot				
661530	3.0 x 100 mm	Icon	2	4 009316 615300
661540	4.0 x 125 mm	Icon	2	4 009316 615409
661555	5.5 x 150 mm	Icon	2	4 009316 615553

Nail lifting bar

PROFESSIONAL ★★★★★

CrV steel, 3-component grip for optimal power transfer and slip-free working, matt chrome plated, with chemically blacked precision tips, with shovel for nails up to a shaft diameter of 2.5 mm. Quickly distinguishable colour code system shows the desired blade shape. With practical screwdriver holder for the workshop, simply screw the plastic clip on the workshop wall.

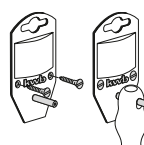

Art.-No.	mm x mm	Icon	Quantity	Barcode
664620	6.0 x 100 mm	Icon	2	4 009316 646205

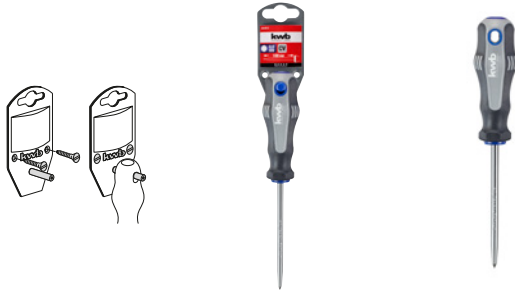

CrV steel, 3-component grip for optimal power transfer and slip-free working, matt chrome plated, with chemically blacked precision tips, for pricking of openings in wood for easier screw centring. Quickly distinguishable colour code system shows the desired blade shape. With practical screwdriver holder for the workshop, simply screw the plastic clip on the workshop wall.

Art.-No.	mm X mm	Icon	Icon	Barcode
664610	6.0 x 100 mm	Icon	2	4 009316 646106

CV



Screwdriver with flexible blade

PROFESSIONAL ★★★★★

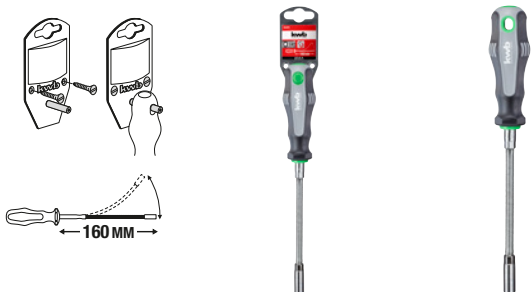

CrV steel, flexible blade, 3-component grip for optimal power transfer and fatigue-free working, allows screwdriving in areas difficult to access. With practical screwdriver holder for the workshop, simply screw the plastic clip on the workshop wall.



Art.-No.	Fitting	Length	Icon	Icon	Barcode
664630	Hexagon 1/4"	160 mm	Icon	2	4 009316 646304



PACKAGING CLIP CAN BE USED AS CONVENIENT TOOL HOLDER

MUST HAVE

Simply fix the clip with 2 screws on the tool wall ...

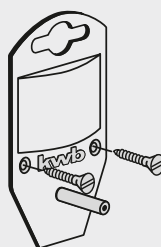

... then hang up the screwdrivers - and have the right screwdrivers readily to hand!



VDE screwdrivers

VDE insulated screwdriver

PROFESSIONAL ★★★★★



VDE certified, CrV steel, 3-component grip for optimal power transfer and non-slip working, blades fully insulated, with chemically blacked precision tips. Quickly distinguishable colour code system shows the desired blade shape. With practical screwdriver holder for the workshop, simply screw the plastic clip on the workshop wall.

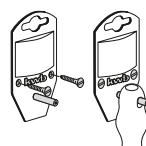

1000 V

CV



Art.-No.	mm x mm			Barcode
⊕ Cross slot / Phillips				
662300	PH0 x 75 mm		2	4 009316 623008
662301	PH1 x 80 mm		2	4 009316 623015
662302	PH2 x 100 mm		2	4 009316 623022

VDE insulated screwdriver

PROFESSIONAL ★★★★★



VDE certified, CrV steel, 3-component grip for optimal power transfer and non-slip working, blades fully insulated, with chemically blacked precision tips. Quickly distinguishable colour code system shows the desired blade shape. With practical screwdriver holder for the workshop, simply screw the plastic clip on the workshop wall.

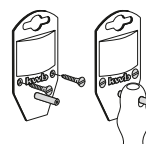

1000 V

CV



Art.-No.	mm x mm			Barcode
⊕ Pozidriv				
663300	PZ0 x 75 mm		2	4 009316 633007
663301	PZ1 x 80 mm		2	4 009316 633014
663302	PZ2 x 100 mm		2	4 009316 633021

VDE insulated screwdriver

PROFESSIONAL ★★★★★



VDE certified, CrV steel, 3-component grip for optimal power transfer and non-slip working, blades fully insulated, with chemically blacked precision tips. Quickly distinguishable colour code system shows the desired blade shape. With practical screwdriver holder for the workshop, simply screw the plastic clip on the workshop wall.

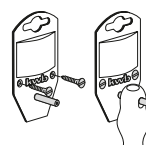

1000 V

CV



Art.-No.	mm x mm			Barcode
⊖ Plain slot				
661325	2.5 x 80 mm		2	4 009316 613252
661330	3.0 x 75 mm		2	4 009316 613306
661336	3.5 x 100 mm		2	4 009316 613368
661340	4.0 x 100 mm		2	4 009316 613405
661355	5.5 x 125 mm		2	4 009316 613559
661365	6.5 x 150 mm		2	4 009316 613658



VDE certified, CrV steel, 3-component grip for optimal power transfer and non-slip working, blades fully insulated, with chemically blacked precision tips. Quickly distinguishable colour code system shows the desired blade shape.

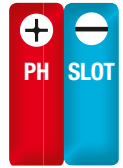

1000 V

CV



Art.-No.	Content			Barcode
665307	⊕PH1 80 mm PH2 100 mm ⊖2.5 x 80 mm 4.0 x 100 mm 5.5 x 125 mm 6.5 x 150 mm 1 Voltage tester		2	4 009316 653074

kwb Info



VDE insulation - safe working on live electrical installations







There are strict health and safety standards relating to work on live electrical installations, such as the German DIN VDE 0105 or the international EN 50110 as well as IEC 60364, kwb tools which bear the special ⚡ 1000 V symbol are authorised for live working use up to 1000 V AC.





Voltage testers

Voltage tester VDE

HIGH QUALITY ★★★★★

VDE GS certified, 125 - 250 Volt, with optical display, with pocket clip, insulated head and blade, to detect whether voltage is present

Art.-No.			Barcode
142900	3,5 x 100 mm	2	
142911	3,5 x 100 mm	10	
143000	3,0 x 70 mm	2	
143011	3,0 x 70 mm	20	





Art.-No.			Barcode
142992	3,5 x 100 mm	100	
143092	3,0 x 70 mm	150	



Voltage tester, VDE

HIGH QUALITY ★★★★★

VDE GS certified, 125 - 250 Volt, with all-round hand guard and easy-to-read display, to detect whether voltage is present



Art.-No.			Barcode
143100	3,0 x 150 mm	2	
143200	3,5 x 190 mm	2	



2-pole voltage tester

PROFESSIONAL ★★★★★

TÜV GS tested, 2-pole voltage tester with 7 LED polarity indicators, for measuring whether voltage is present and for testing continuity, professional measuring of direct or AC voltages with testing ranges of 6V, 12V, 24V, 50V, 120V, 220V, 400V, Power supply: with or without battery, probe cable 83cm long, probe length 20mm, dust and moisture resistant housing IP54, for indoor and outdoor use, CAT III max. 400 V, complies with IEC/EN 61243-3 (DIN VDE 0411)

Art.-No.	Content		Barcode
142400	2-pole voltage tester 2 x 1.5V micro batteries LR44 included	2	







Car light tester

HIGH QUALITY ★★★★★



24 volt, 120 mm long, with 10 mm pointed probe and screw-on protective cap, 85 cm cable with crocodile clip

Art.-No.	Content			Barcode
142600	Car lighting tester, 24 Volt		2	 4 009311 426000

T-grip screwdrivers

T-grip screwdriver

PROFESSIONAL ★★★★★



with hanger for the workshop wall, simply screw the plastic clip on the workshop wall. CrV steel, 2-component grip for high power transfer and slip-free working, chrome plated, short and long blade, for significantly more powerful working as compared to conventional screwdrivers. Colour code system on the package for easier allocation to different applications.

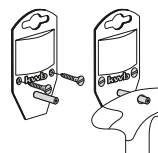

Art.-No.	$\frac{+}{-}$ mm	mm x mm			Barcode
● Nut					
689510	95 mm	SW10 7,0 x 230 mm		2	4 009316 895108
689513	95 mm	SW13 8,0 x 230 mm		2	4 009316 895139
689517	95 mm	SW17 8,0 x 230 mm		2	4 009316 895177
689508	95 mm	SW8 7,0 x 230 mm		2	4 009316 895085

T-grip screwdriver

PROFESSIONAL ★★★★★



with hanger for the workshop wall, simply screw the plastic clip on the workshop wall. CrV steel, 2-component grip for high power transfer and slip-free working, chrome plated, short and long blade, for significantly more powerful working as compared to conventional screwdrivers. Colour code system on the package for easier allocation to different applications.

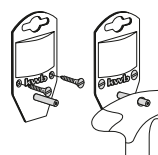

Art.-No.	$\frac{+}{-}$ mm	mm x mm			Barcode
● HEX					
689603	70 mm	3,0 x 125 mm		2	4 009316 896037
689604	70 mm	4,0 x 125 mm		2	4 009316 896044
689605	70 mm	5,0 x 150 mm		2	4 009316 896051
689606	70 mm	6,0 x 150 mm		2	4 009316 896068
689608	95 mm	8,0 x 175 mm		2	4 009316 896082
689610	95 mm	10,0 x 200 mm		2	4 009316 896105



with hanger for the workshop wall, simply screw the plastic clip on the workshop wall. CrV steel, 2-component grip for high power transfer and slip-free working, chrome plated, short and long blade, for significantly more powerful working as compared to conventional screwdrivers. Colour code system on the package for easier allocation to different applications.

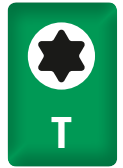

CV



Art.-Nr.	mm	mm x mm	Icon 1	Icon 2	EAN
⊕ T					
689706	70 mm	T6 3,0 x 105 mm	Icon 1	2	4 009316 897065
689708	70 mm	T8 3,0 x 105 mm	Icon 1	2	4 009316 897089
689710	70 mm	T10 3,0 x 125 mm	Icon 1	2	4 009316 897102
689715	70 mm	T15 4,0 x 125 mm	Icon 1	2	4 009316 897157
689720	70 mm	T20 4,0 x 125 mm	Icon 1	2	4 009316 897201
689725	95 mm	T25 4,5 x 150 mm	Icon 1	2	4 009316 897256
689730	95 mm	T30 6,0 x 150 mm	Icon 1	2	4 009316 897300
689740	95 mm	T40 8,0 x 150 mm	Icon 1	2	4 009316 897409

PACKAGING CLIP CAN BE USED AS CONVENIENT TOOL HOLDER

MUST HAVE

Simply fix the clip with 2 screws on the tool wall ...

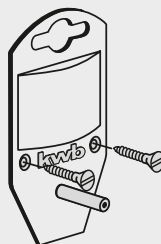

... then hang up the screwdrivers - and have the right screwdrivers readily to hand!



PROFI precision screwdrivers

kwib
GERMANY GMBH

PROFI precision screwdriver set, 6pc.

PROFESSIONAL ★★★★★

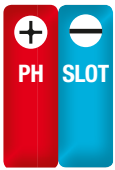

CrV steel, 2-component grip, with rotating top for optimal power transfer and easy operation in precision work, matt chrome plated, with chemically blacked precision tips, in plastic cassette



Art.-No.	Content			Barcode
146100	⊖ Slot 1.5, 2.0, 2.5, 3.0 mm ⊕ Cross No. 00, No. 0		4	

CV



PROFI precision screwdriver set, 7pc.

PROFESSIONAL ★★★★★

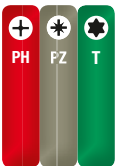

CrV steel, 2-component grip, with rotating top for optimal power transfer and easy operation in precision work, CrV steel blades, matt chrome plated, with chemically blacked precision tips, in plastic cassette



Art.-No.	Content			Barcode
146200	⊖ Slot 2.0, 2.5, 3.0 mm ⊕ Cross Nr. 00, Nr. 0 ⊕ T 15, T 20		4	

CV



PROFI precision screwdriver set, 7pc.

PROFESSIONAL ★★★★★



CrV steel, 2-component grip, with rotating top for optimal power transfer and easy operation in precision work, CrV steel blades, matt chrome plated, with chemically blacked precision tips, in plastic cassette



Art.-No.	Content			Barcode
146400	⊕ T6, T7, T8, T9, T10, T16, T20		4	

CV



PROFI precision screwdriver set, 8pc.

PROFESSIONAL ★★★★★

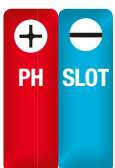

CrV steel, 2-component grip, with rotating top for optimal power transfer and easy operation in precision work, with interchangeable CrV steel blades, matt chrome plated, with chemically blacked precision tips, in plastic cassette



Art.-No.	Content			Barcode
146600	⊖ / ⊕ Flat/Cross 2.0 mm x Nr. 00 3.0 mm x Nr. 0, 4.0 mm x Nr. 1 ⊕ T5 x T20, T6 x T15, T7 x T9, T8 x T10		4	

CV



kwb screwdrivers

PROFI precision screwdriver set, 6pc.

PROFESSIONAL ★★★★★



VDE certified, CrV steel, 2-component grip, with rotating top for optimal power transfer and convenient working in precision engineering, blades fully insulated, with chemically blacked precision tips, in plastic cassette



1000 V







Art.-No.	Content			Barcode
146800	⊕ Cross/Phillips Nr. 00 x 65 mm Nr. 0 x 65 mm, Nr. 1 x 65 mm ⊖ Flat 2.0 x 65 mm, 2.5 x 65 mm 3.0 x 65 mm		4	 4 009311 468000

Special screwdrivers

4 in 1 screwdriver

HIGH QUALITY ★★★★★



Screwdriver with 4 reversible blades, always the right bit to hand, easy insertion and removal of screws, with 2-component handle for optimal power transfer and non-slip working

Art.-No.	Content			Barcode
117092	⊖ / ⊕ PH 5.0 mm + Nr. 2 ⊕ Nr. 1 + Nr. 2		24	 4 009311 170927



Magnetic screwdriver

QUALITY ★★★★★

Art.-No.	Length			Barcode
116410	225 mm		2	 4 009311 164100

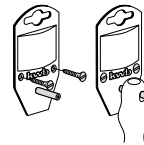

Ratchet angle screwdriver

QUALITY ★★★★★

3 position handle: left rotation, right rotation and locked. Angle locking at 0° - 45° - 90°.

Art.-No.	Length			Barcode
116210	200 mm		2	 4 009311 162106

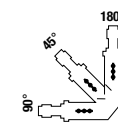
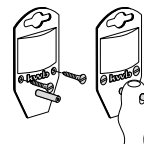



kwb Germany GmbH
Hauptstraße 132
D - 28816 Stuhr

Tel.: + 49 (0) 421 8994-0
Fax: + 49 (0) 421 8994-103

welcome@kwb.eu
www.kwb.eu



Art.-Nr. 990389 - GB